



Kingsclere Village Club
Charity Registration Number 1189234

INFORMATION FOR FIRE SERVICE

Committee/Keyholder Contacts	1
Ground Floor Layout, Utilities and Hazards	2
First Floor Layout, Utilities and Hazards	3

1. Committee/Keyholder Contacts

- Booking Secretary: Emma Hartley 01635 297913 or 07849 653809
bookings@kingsclerervillageclub.co.uk
- Chairman: Sharon Morris 01635 298370 or 07576249814
chairman@kingsclerervillageclub.co.uk
- Treasurer: Helen Andrew 01635 297390 or 07887 653809
treasurer@kingsclerervillageclub.co.uk

Kingsclere Village Club | 35 George Street | Kingsclere | Hampshire | RG20 5NH

clerk@kingsclerervillageclub.co.uk

<http://kingsclerervillageclub.co.uk>

ref 2022.7 FireServiceInfo

2. Ground Floor Layout, Utilities and Hazards

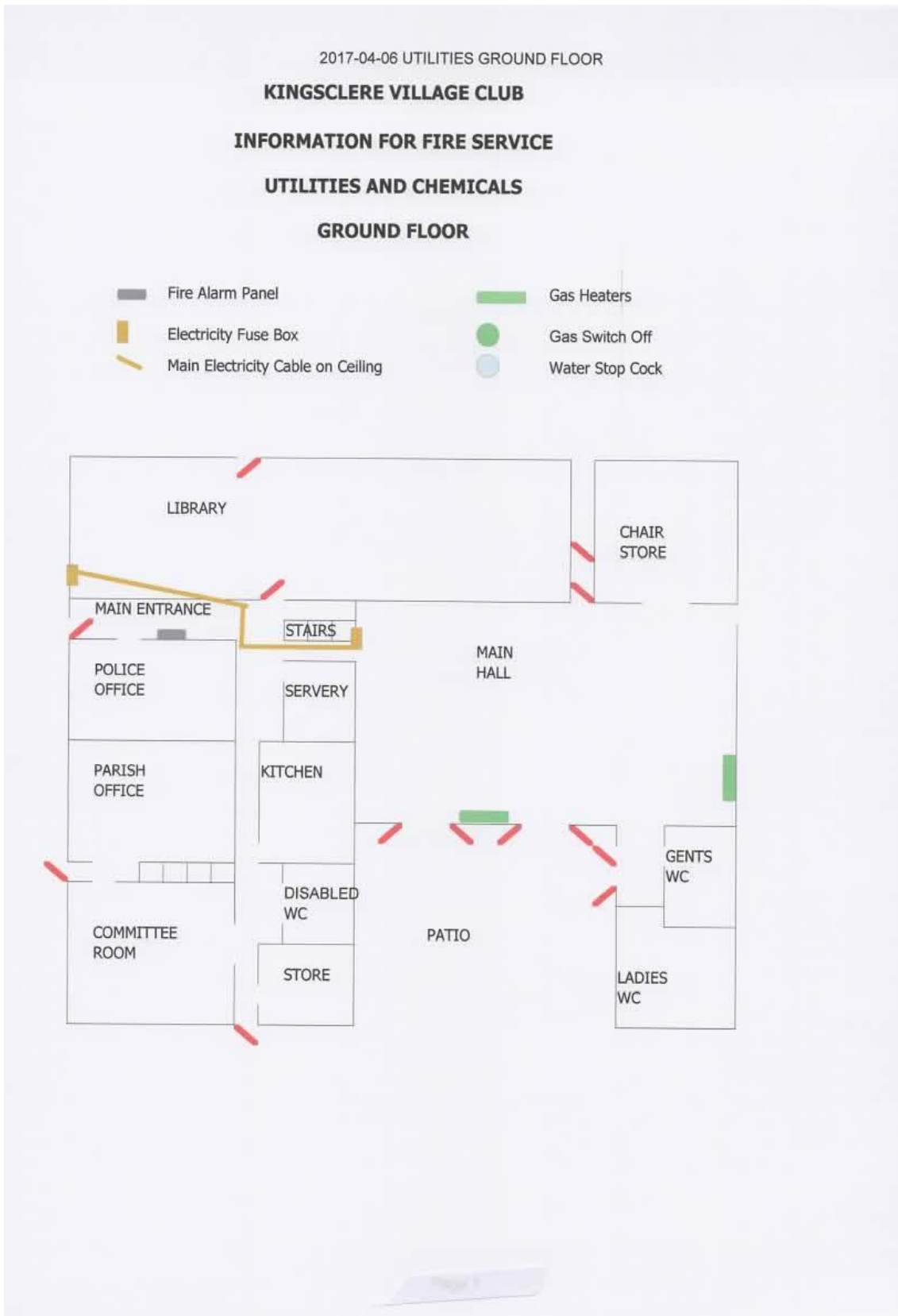

Ground Floor

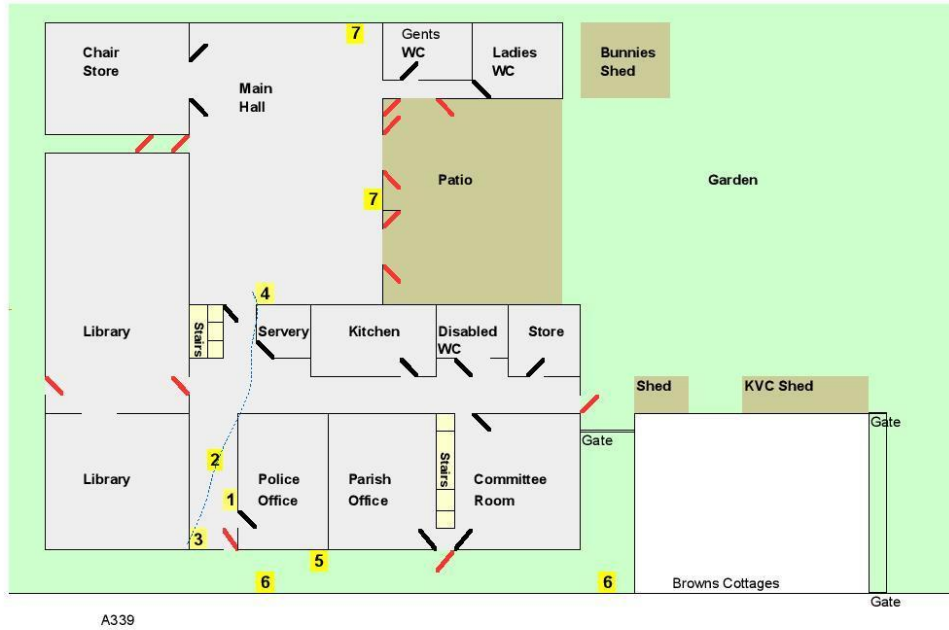

- | | |
|--|-------------------------------------|
| H Water Hydrant | 1 Fire Panel |
| 2 Mains Electricity Cable – Ceiling Mounted Plastic clips | 3 Main Electrical Fuse Boxes |
| 4 Fuse Box for Main Hall and Toilet Block | 5 Gas Main switch off |
| 6 Water Main | 7 Gas Wall Heater |

3. First Floor Layout, Utilities and Hazards

